



Invest at the landmark location of  
**Old Delhi, Chandni Chowk**



**RERA Registration No. DLRERA2022P0015**

**DISCLAIMER :** The DESIGN/ELEVATION AND LOCALITY/VICINITY of the Project contained in this BROCHURE are photographic and artistic impressions and are for ILLUSTRATIVE PURPOSES only and should not be relied upon when making a decision to purchase. The Developer does not take any responsibility for inaccuracy or variations in the illustration and information as depicted in the brochure.

**Call Us For Booking: 8700 190 507**

## About The Company

We are a group from Delhi NCR, with expertise in several industries. With our residential, commercial, hospitality, and industrial projects, we are the fastest-growing developers in the Delhi NCR region.

We have completed the delivery of 5 million square feet, and currently have a base of 10,000+ satisfied clients.



## About The Management

One of the most seasoned real estate developers in the National Capital Region, Mr. Pradeep Kumar Agrawalla, Chairman of the Galaxy Group, has close to 13 years of expertise. Born and raised in Barapali, Odisha, Mr. Agrawalla, 55, launched his Diamond Firm in the year 1983, under the name of Galaxy Diamond. He established industry standards while conducting business in Bangkok, Belgium, Hongkong, Mumbai, and other countries. Mr. Agrawalla's far-sighted and diverse perspective inspired him to enter the real estate market, where he has garnered praise from customers and influential members of the sector. With the purchase of more major commercial properties and the beginning of his development plans, Mr. Agrawalla is continuing his journey with dedication and enthusiasm.

## About the Project

Chandni Chowk, the biggest shopping hub in Delhi, is a market that has been around for more than three centuries and is famous not only in India but worldwide. It brings back the full charm of medieval bazaar experience with narrow lanes, small shops, lined by hawkers and porters, where one can find everything. Having said that, Chandni Chowk lacks a highstreet shopping experience that meets the demands of the modern and growing population.

Novelty Street is all set to redefine the shopping experience both for buyers and sellers. Designed beautifully, this upcoming commercial comprises a combination of classical and colonial architecture. Further the complex will offer facilities such as lifts, hygiene-friendly toilets and 24/7 security with CCTV surveillance etc. It also will enjoy maximum accessibility due to the fact that it is a three side open plot.

Chandni Chowk is one of the most populous and busiest areas in Delhi NCR; it is estimated that there is 4-6 lakh footfall per day. It not only attracts locals, but also tourists from many different countries. As highlighted above, the modern facilities combined with the excellent location is sure to enhance the overall shopping experience.



## Specifications

<b>FLOORING</b>	Vitrified, Ceramic tiles/Brands Kajaria/Somany
<b>WALLS</b>	Plastered Walls
<b>CEILING</b>	Exposed Roof Slab
<b>DOORS</b>	Toughened Glass Door at Shop Front
<b>SHOP FRONT</b>	Toughened glass with space for signage
<b>FIRE FIGHTING</b>	As per Fire Department norms
<b>POWER BACKUP</b>	24 Hrs. Power backup (on demand)
<b>AIR CONDITIONING</b>	DX Package unit/VRV system for air conditioning

## Lobby & Common Areas

<b>FLOORING</b>	Stone Flooring/Vitrified Tiles Brands Kajaria/Somany or equivalent
<b>CEILING</b>	Gypsum Board/Mineral Fiber grid ceiling/Metal ceiling with paint
<b>WALLS &amp; PAINTING</b>	Emulsion Paint/Shop front stone cladding
<b>RAILING</b>	Stone Baluster Railing
<b>ELECTRICITY</b>	Common area electrical work with corridor lighting
<b>FIRE FIGHTING</b>	As per Fire Department norms
<b>CCTV</b>	24x7 Security with CCTV Surveillance
<b>STAIRCASE</b>	Stone flooring

## Landscaping

<b>HARDSCAPE</b>	Tiles/Trimix/Concrete pavers/Kerb stone/Stone
<b>INTERNAL ROADS</b>	Trimix flooring/Pavers
<b>LIGHTING</b>	As per design/Well lit premises/Solar enabled street light
<b>SOFTSCAPE</b>	Natural grass/Plants/Trees etc.
<b>CCTV</b>	24x7 Security with CCTV Surveillance

## *Basement Area*

<b>FLOORING</b>	Trimix flooring
<b>LIGHTING</b>	LED/Ceiling mounted light
<b>COMMON PARKING</b>	Mechanical Parking (as per sanctioned plan)
<b>CCTV</b>	24x7 Security with CCTV Surveillance
<b>VENTILATION</b>	As per Fire Dept norms
<b>FIRE FIGHTING</b>	As per Fire Dept norms
<b>LIFT</b>	1 Car Lift

## *Lift*

<b>LIFT</b>	2 Passenger Lifts and 1 Car Lift
-------------	----------------------------------

## *Common Toilets*

<b>FLOORING</b>	Italian Marble/Granite
<b>CEILING</b>	Gypsum Board/Mineral Fiber grid ceiling
<b>WALLS</b>	Porcelain/Ceramic Tiles Brands Kajaria/Somany or equivalent
<b>CHINAWARE &amp; C.P FITTINGS</b>	Wall hung W.C., W.B. URINAL (Kohler/Jaquar/ Roca/ Toto or equivalent) and Hand Mixer, Faucet (Kohler/ Jaquar/ Roca/ Toto or equivalent)

## *Sewerage System & Solid Waste Management*

<b>SEWERAGE SYSTEM</b>	N/A
<b>SOLID WASTE MANAGEMENT AND DISPOSAL SYSTEM</b>	Garbage collection system at door step & compost by machine

# Ground Floor Plan

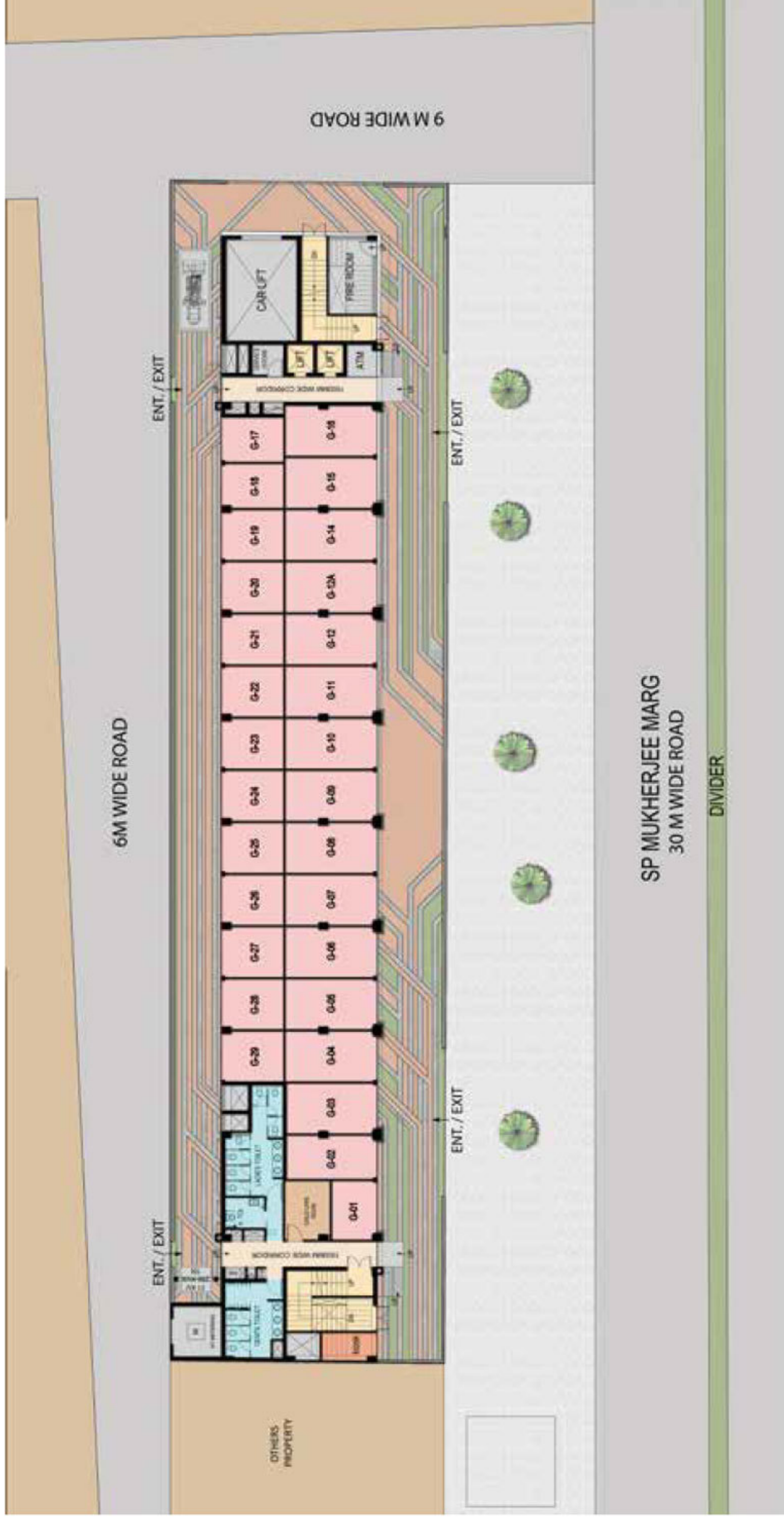

LEGENDS	
SHOP	
KIOSK	
CORRIDOR	
CORE	
SERVICES/SHAFTS	
CHILD CARE ROOM	

**DISCLAIMER :** The DESIGN/ELEVATION AND LOCALITY/VICINITY of the Project contained in this BROCHURE are photographic and artistic impressions and are for ILLUSTRATIVE PURPOSES only and should not be relied upon when making a decision to purchase. The Developer does not take any responsibility for inaccuracy or variations in the illustration and information as depicted in the brochure.

# First Floor Plan

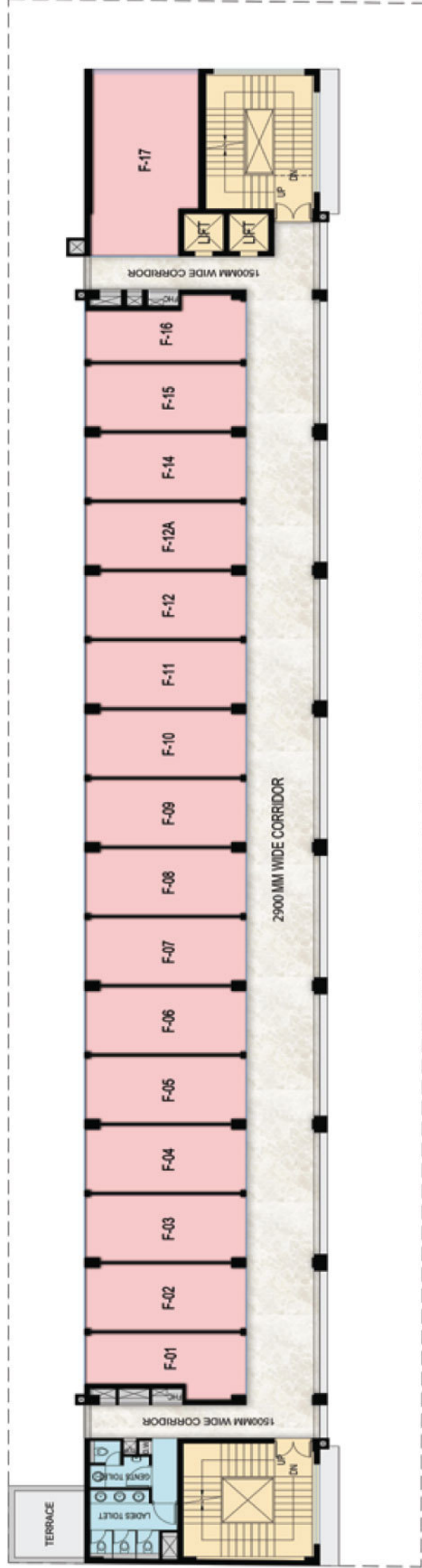

LEGENDS	
	SHOP
	CORRIDOR
	CORE
	SERVICES/SHAFTS

**DISCLAIMER :** The DESIGN/ELEVATION AND LOCALITY/VICINITY of the Project contained in this BROCHURE are photographic and artistic impressions and are for ILLUSTRATIVE PURPOSES only and should not be relied upon when making a decision to purchase. The Developer does not take any responsibility for inaccuracy or variations in the illustration and information as depicted in the brochure.

# Second Floor Plan

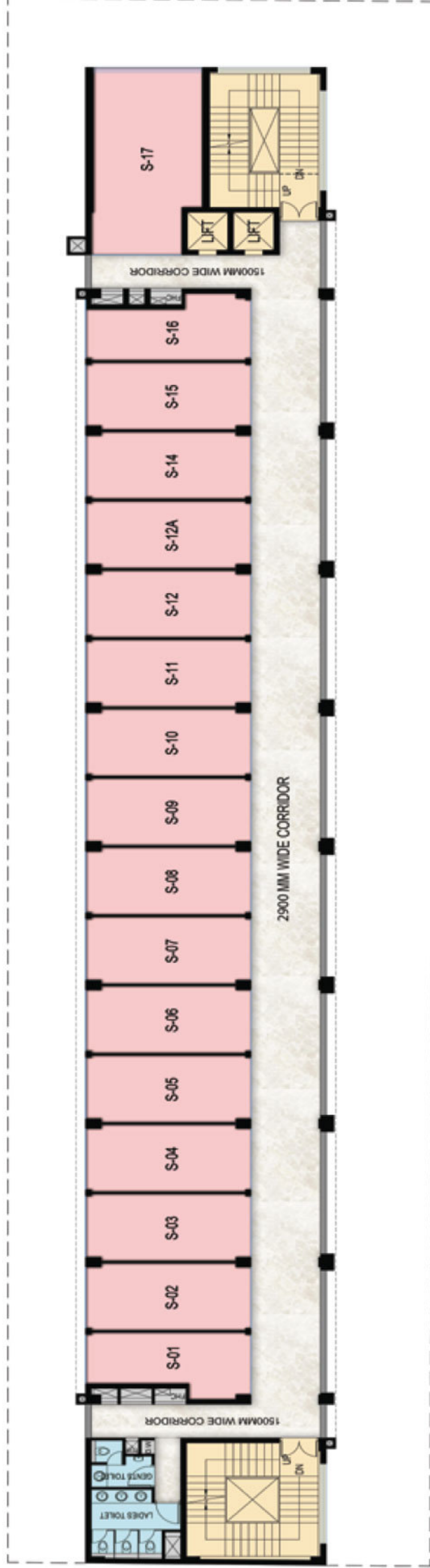

LEGENDS
SHOP
CORRIDOR
CORE
SERVICES/SHAFTS

**DISCLAIMER :** The DESIGN/ELEVATION AND LOCALITY/VICINITY of the Project contained in this BROCHURE are photographic and artistic impressions and are for ILLUSTRATIVE PURPOSES only and should not be relied upon when making a decision to purchase. The Developer does not take any responsibility for inaccuracy or variations in the illustration and information as depicted in the brochure.

## *Retail Shops & Food Street*



---

**DISCLAIMER :** The DESIGN/ELEVATION AND LOCALITY/VICINITY of the Project contained in this BROCHURE are photographic and artistic impressions and are for ILLUSTRATIVE PURPOSES only and should not be relied upon when making a decision to purchase. The Developer does not take any responsibility for inaccuracy or variations in the illustration and information as depicted in the brochure.



*A new revolution in Chandni Chowk  
Where tradition meets the modern*



**DISCLAIMER :** The DESIGN/ELEVATION AND LOCALITY/VICINITY of the Project contained in this BROCHURE are photographic and artistic impressions and are for ILLUSTRATIVE PURPOSES only and should not be relied upon when making a decision to purchase. The Developer does not take any responsibility for inaccuracy or variations in the illustration and information as depicted in the brochure.

## *Chandni Chowk, a slice of dil walo ki Delhi.*

- ◆ India's oldest & busiest market since the Mughal era
- ◆ Asia's major feeder market for both wholesale & retail trade
- ◆ Surrounded by UN World heritage sites (e.g. Red Fort) in addition to other historical landmarks
- ◆ The kingdom of street food

Delhi attracts 1/3rd of India's foreign tourists i.e. more than 30 lakhs and domestic tourist traffic of approx. 4 Crore annually. Most of these tourists visit Chandni Chowk.

### *Current Footfall*

- ◆ 4 to 6 lakh footfalls per day

# Diverse Retail Base

## Tourist hotspot

Red Fort | Fatehpuri Masjid  
Chunnamal ki Haveli  
Mirza Ghalib's Haveli  
Jama Masjid | Town Hall

## Commercial hub

Textiles | Clothing  
Books & Stationery | Spices  
Electronics | Consumer Goods  
Embroidery | Leather Goods  
Home Furnishing | Jewellery

## Foodies corner

Giani's Sweets | Karim's  
Kake Di Hatti  
Natraj Dahi Bhalle | Parathe Wali Gali  
Chainaram Halwai | Sita Ram Bazar



Meena Bazaar



Johri Bazaar



Kinari Bazaar



Bhagirath Palace



Jama Masjid



Fatehpuri Masjid



Old Delhi Railway Station



Red Fort



Town Hall

# Noida | Noida Extension Projects

## DELIVERED PROJECTS



**GALAXY NORTH AVENUE-II**  
2/3/4 BHK HOMES, GNIDA WEST



**GALAXY VEGA**  
2/3 BHK HOMES, GR. NOIDA (WEST)



**GALAXY royale**



**Galaxy Plaza**  
Greater Noida (West)



**GALAXY diamond plaza**  
GR. NOIDA WEST



**GALAXY BLUE SAPPHIRE PLAZA**  
GREATER NOIDA WEST

## ONGOING PROJECTS



**sawasdee JLR galleria**  
Experiences Beyond Luxury  
SECTOR 63



**sawasdee CENTRE**  
VASHUNDRA



**SAWASDEE Street**  
RAJ NAGAR EXTENSION

# Delhi Projects

## ONGOING PROJECTS



## OTHER PROJECTS

**Galaxy  
Shoppe**  
GAUR CITY Greater Noida (West)

galaxy  
Green  
**arcade**



**DISCLAIMER :** The DESIGN/ELEVATION AND LOCALITY/VICINITY of the Project contained in this BROCHURE are photographic and artistic impressions and are for ILLUSTRATIVE PURPOSES only and should not be relied upon when making a decision to purchase. The Developer does not take any responsibility for inaccuracy or variations in the illustration and information as depicted in the brochure.

# Location Map



**ASTEROID SHELTERS HOMES PRIVATE LIMITED**

CIN No.: U U70200DL2012PTC245035

**RERA Registration No. DLRERA2022P0015**

**Site Office:** Novelty Cinema Land, Main Road, SPM Marg, Near Old Delhi Railway Station, Delhi- 110006

**DISCLAIMER :** The DESIGN/ELEVATION AND LOCALITY/VICINITY of the Project contained in this BROCHURE are photographic and artistic impressions and are for ILLUSTRATIVE PURPOSES only and should not be relied upon when making a decision to purchase. The Developer does not take any responsibility for inaccuracy or variations in the illustration and information as depicted in the brochure.

**Call Us For Booking: 8700 190 507**